

Rainbird ESP MODULAR

https://www.rainbird.com/sites/default/files/media/documents/2018-02/man_ESPModular_CN.pdf

Auto= is set for watering 3 days per week (Monday, Thursday, Saturday).

- If too wet, turn the system to off. Turn back to auto when you want to start watering again.
- If too dry, use the seasonal adjust (increase the percentage) OR add more watering days on Friday and Sunday.

Please do not water and Tuesday and Wednesday so that yards are dry for Wednesday mowing, this decreases the risk of damage to yards from mowing.

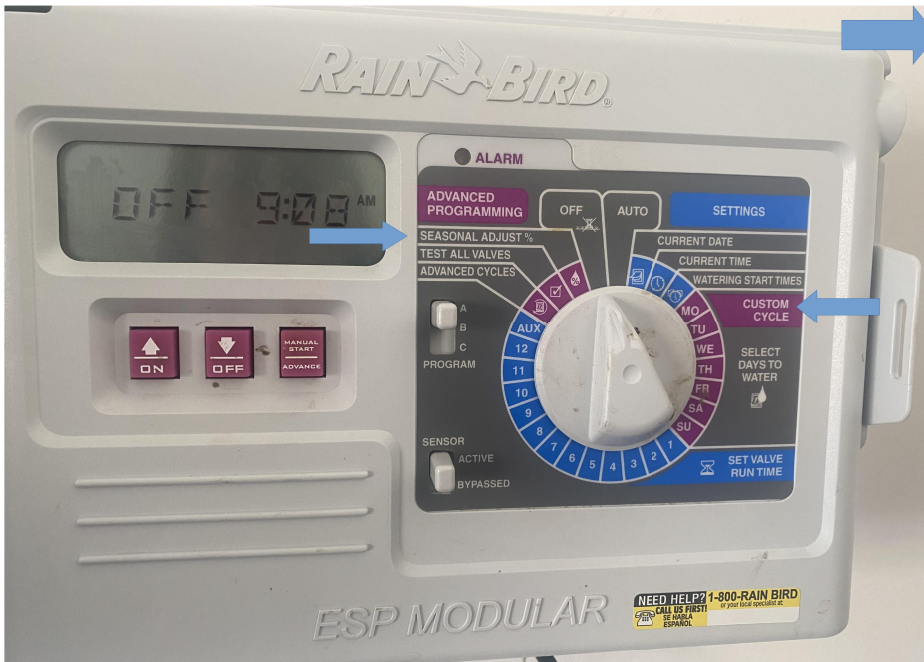

VII. SET SEASONAL ADJUST % (Water Budget) %

This function lets you increase or decrease the run times of all valves globally by a selected percentage. You can set the % from 0-200%. This setting will affect ALL programs globally.



Use to adjust time up or down. Default is 100%.

Seasonal adjust % is calculated on the normal programmed run times for each valve. For example, if valve 1 is set to run for 10 minutes, and you set it to 120%, valve 1 will run for 12 minutes.



Caution: If a value other than the default 100% is entered, the % will be displayed in AUTO mode to indicate run time values are adjusted.

A. 1 7 (Custom / Day of Week)

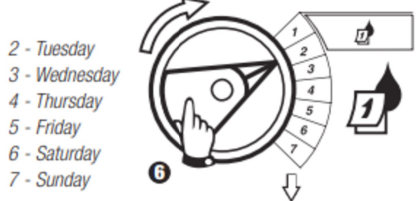
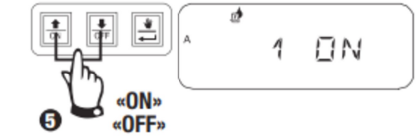
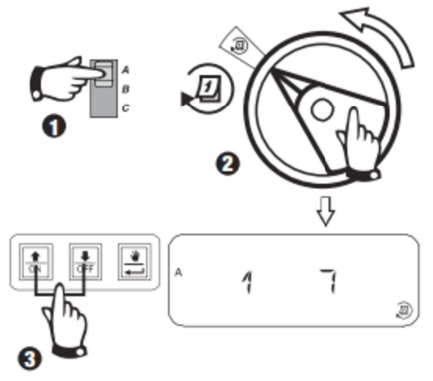

- 2 - Tuesday
- 3 - Wednesday
- 4 - Thursday
- 5 - Friday
- 6 - Saturday
- 7 - Sunday



